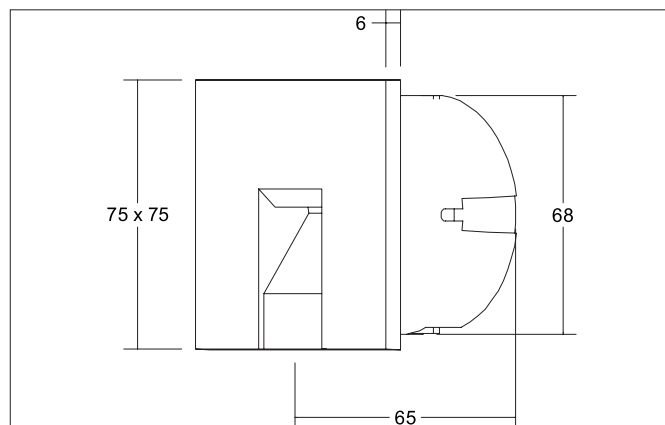

**WALL KIT68 LED wall recessed light WALL KIT68, for device socket**

Artikel-Nr. 10157073

Licht.  
Für Generationen.**Tender**

LED wall recessed light WALL KIT68, for device socket, white, square. Recessed mounting, Wall-mounted. For installation in cavity wall or concrete device boxes with an installation depth of at least 62 mm (screw distance: 60 mm). Compatible with Kaiser device sockets for cavity wall installation, product no. 9064-02 or 9464-02 or concrete installation, product no. 1556-04. Attention! The delivery is WITHOUT a device socket. Mounting method: Recessed mounting, Place of installation: Wall-mounted, Material: Aluminium / Steel / Plastic, Degree of protection: according to DIN EN 60529 IP20, Protection class: (EN 61140) I, Voltage: 230V AC 50Hz, Power: 1.5W, Amount of light sources / fittings: 1.0 Qty, Luminous flux: 70lm, Colour temperature: 3.000 K, Light colour : White, With control gear: Yes, Control: on/off.

Article data	
Artikel-Nr.	10157073
GTIN	4251433925644
Series name	WALL KIT68
Kurzbeschreibung	LED wall recessed light WALL KIT68, for device socket
Material	Aluminium / Steel / Plastic
Colour	White
Shape	square
Built-in diameter	68 mm
Installation depth	65 mm
Length	75 mm
Width	75 mm
Aufbauhöhe	50 mm
weight	0.165 kg

**WALL KIT68 LED wall recessed light WALL KIT68, for device socket**

Artikel-Nr. 10157073

Licht.  
Für Generationen.

Lighting technology	
Colour temperature	3000 K
Light colour	White
Luminous flux	70 lm
System efficiency	47 lm/W
Colour rendering	CRI > 90
Reflector	Without
Light sharing	Symmetric

Operating technology of the luminaires	
System output	1.5 W
Voltage type	AC
AC nominal voltage max	230 V
Frequenz max.	50 Hz
Lamp	LED
Protection class	I
Degree of protection	IP20
Control	on/off
Leuchtmittelwechsel möglich	ja

Mounting technology	
Mounting method	Recessed mounting
Place of installation	Wall-mounted
Adjustability	Not adjustable
Material cover	Without cover

Packing data	
Gross weight	0.206 kg
Length of packaging	90 mm
Packaging width	55 mm
Packaging height	109 mm