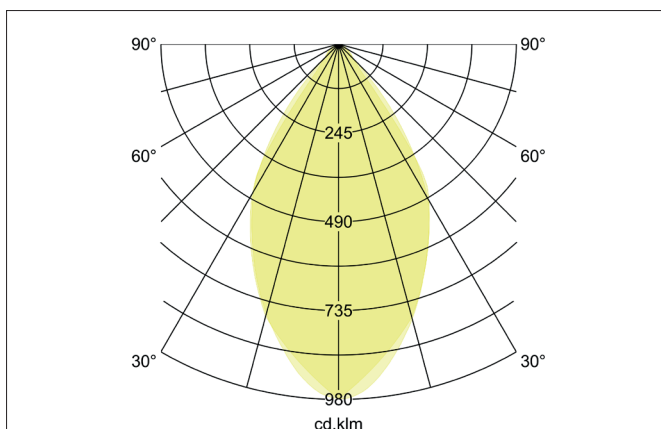
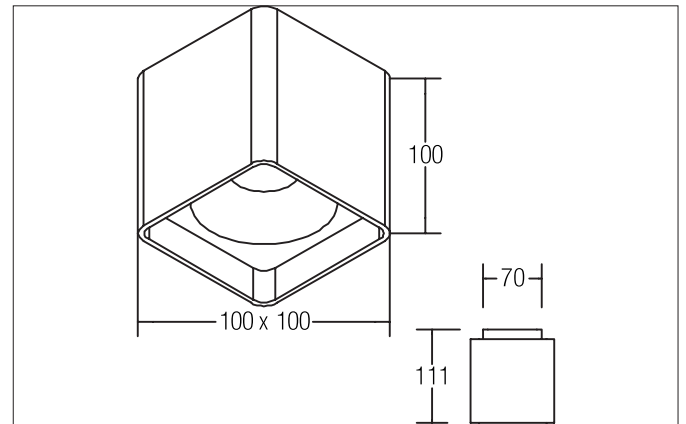

**QUBIC LED surface mounted downlight QUBIC**

Artikel-Nr. 12040173

Licht.  
Für Generationen.**Tender**

LED surface mounted downlight QUBIC, white, square. Surface mounting, Ceiling-mounted. LED ceiling mounted downlight with 9.5 W / 930 lm direct and 1.5 W / 150 lm indirect light component Mounting method: Surface mounting, Place of installation: Ceiling-mounted, Material: Aluminium / Plastic, Degree of protection: according to DIN EN 60529 IP20, Protection class: (EN 61140) I, Voltage: 230V AC 50Hz, Power: 10.5W, Amount of light sources / fittings: 1.0 Qty, Luminous flux: 1.080lm, Colour temperature: 3.000 K, Light colour : White, Beam angle: 60°, With control gear: Yes, Control: on/off.

| Article data      |   |
|-------------------|---|
| Artikel-Nr.       | 12040173  |
| GTIN              | 4250047798606   |
| Series name       | QUBIC   |
| Kurzbeschreibung  | LED surface mounted downlight QUBIC                       |
| Material          | Aluminium / Plastic                                       |
| Colour            | White   |
| Type of surface   | Matt  |
| Shape             | square  |
| Length            | 100 mm  |
| Width             | 100 mm  |
| Aufbauhöhe        | 110.5 mm  |
| scope of delivery | Incl. converter for connection to the 230-V mains voltage |
| weight            | 1.458 kg  |

**QUBIC LED surface mounted downlight QUBIC**

Artikel-Nr. 12040173

Licht.  
Für Generationen.

| Lighting technology |                 |
|---------------------|-----------------|
| Colour temperature  | 3000 K          |
| Light colour        | White           |
| Light output        | Direct/Indirect |
| Luminous flux       | 1,080 lm        |
| System efficiency   | 103 lm/W        |
| Colour rendering    | CRI > 80        |
| Reflector           | Other           |
| Beam angle          | 60 °            |
| Light sharing       | Symmetric       |

| Operating technology of the luminaires |        |
|--|--------|
| System output                          | 11.5 W |
| Voltage type                           | AC     |
| AC nominal voltage max                 | 220 V  |
| Frequenz max.                          | 50 Hz  |
| Lamp                                   | LED    |
| Protection class                       | I      |
| Degree of protection                   | IP20   |
| Control                                | on/off |
| Leuchtmittelwechsel möglich            | ja     |

| Mounting technology   |                   |
|-----------------------|-------------------|
| Mounting method       | Surface mounting  |
| Place of installation | Ceiling-mounted   |
| Adjustability         | Not adjustable    |
| Material cover        | Glass transparent |

| Packing data        |          |
|---------------------|----------|
| Gross weight        | 1.527 kg |
| Length of packaging | 150 mm   |
| Packaging width     | 120 mm   |
| Packaging height    | 160 mm   |