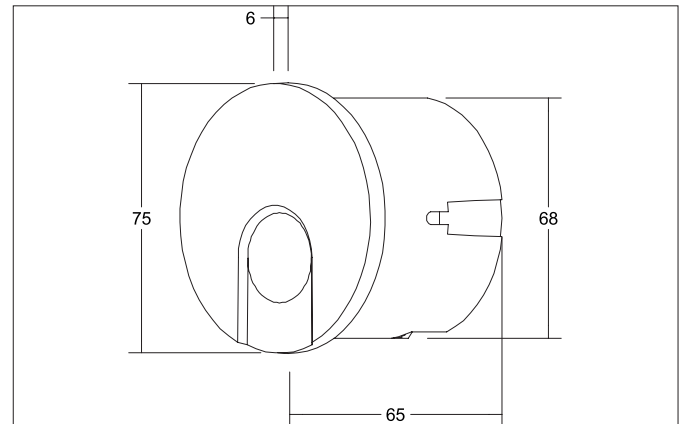
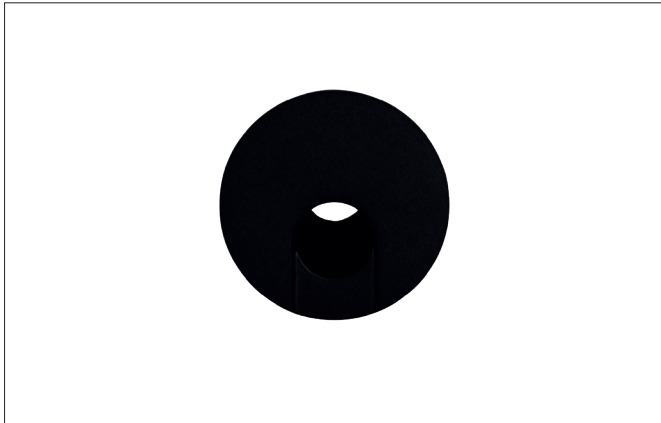

WALL KIT68 LED wall recessed light WALL KIT68, for device socket

Artikel-Nr. 10156083

Licht.
Für Generationen.**Tender**

LED wall recessed light WALL KIT68, for device socket, black, round. Recessed mounting, Wall-mounted. For installation in cavity wall or concrete device boxes with an installation depth of at least 62 mm (screw distance: 60 mm). Compatible with Kaiser device sockets for cavity wall installation, product no. 9064-02 or 9464-02 or concrete installation, product no. 1556-04. Attention! The delivery is WITHOUT a device socket. Mounting method: Recessed mounting, Place of installation: Wall-mounted, Material: Aluminium / Steel / Plastic, Degree of protection: according to DIN EN 60529 IP20, Protection class: (EN 61140) I, Voltage: 230V AC 50Hz, Power: 1.5W, Amount of light sources / fittings: 1.0 Qty, Luminous flux: 70lm, Colour temperature: 3.000 K, Light colour : White, With control gear: Yes, Control: on/off.

| Article data | |
|--------------------|---|
| Artikel-Nr. | 10156083 |
| GTIN | 4251433927051 |
| Series name | WALL KIT68 |
| Kurzbeschreibung | LED wall recessed light WALL KIT68, for device socket |
| Material | Aluminium / Steel / Plastic |
| Colour | Black |
| Shape | round |
| Built-in diameter | 68 mm |
| Installation depth | 65 mm |
| Length | 75 mm |
| Width | 75 mm |
| Aufbauhöhe | 48 mm |
| weight | 0.152 kg |

WALL KIT68 LED wall recessed light WALL KIT68, for device socket

Artikel-Nr. 10156083

Licht.
Für Generationen.

| Lighting technology | |
|---------------------|-----------|
| Colour temperature | 3000 K |
| Light colour | White |
| Luminous flux | 70 lm |
| System efficiency | 47 lm/W |
| Colour rendering | CRI > 90 |
| Reflector | Without |
| Light sharing | Symmetric |

| Operating technology of the luminaires | |
|--|--------|
| System output | 1.5 W |
| Voltage type | AC |
| AC nominal voltage max | 230 V |
| Frequenz max. | 50 Hz |
| Lamp | LED |
| Protection class | I |
| Degree of protection | IP20 |
| Control | on/off |
| Leuchtmittelwechsel möglich | ja |

| Mounting technology | |
|-----------------------|-------------------|
| Mounting method | Recessed mounting |
| Place of installation | Wall-mounted |
| Adjustability | Not adjustable |
| Material cover | Without cover |

| Packing data | |
|---------------------|----------|
| Gross weight | 0.194 kg |
| Length of packaging | 90 mm |
| Packaging width | 55 mm |
| Packaging height | 109 mm |