

smartSWITCH 5DP 14f

Automatic switching based on presence and light level

Product description

- Motion detector for luminaire installation
- For automatic on/off switching of luminaires with electronic ballasts and LED Drivers
- Bright-out function: luminaire is not switched on if there is adequate brightness
- Maximum of 1 sensor possible
- Low-profile casing (21 x 30 mm)
- For a maximum of 2 LED Drivers
- Delay time and light value for the bright-out function can be set via 2 potentiometers



Wiring diagrams and installation examples, page 3

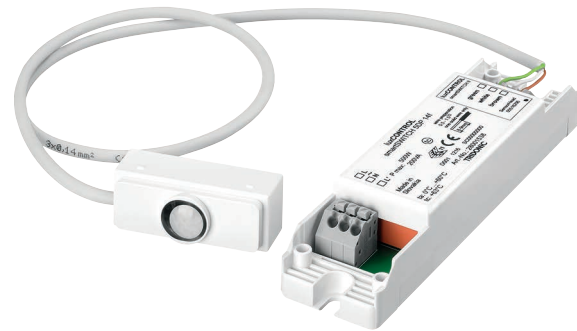
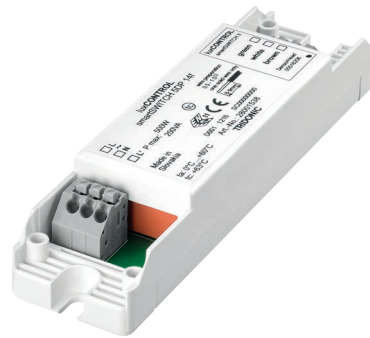



smartSWITCH 5DP 14f

Automatic switching based on presence and light level

Technical data

Rated supply voltage	220 – 240 V
Mains frequency	50 / 60 Hz
Power (output on)	0.6 W
Output, standby (output off)	0.35 W
Ambient temperature ta	0 ... +60 °C

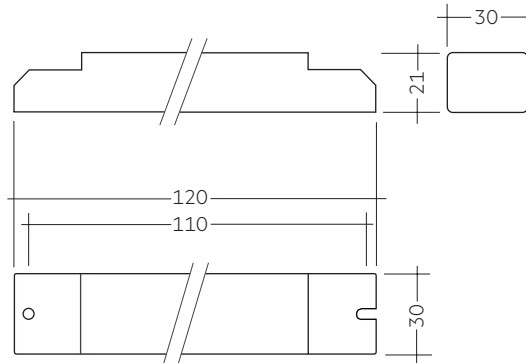

Ordering data

Type	Article number	Packaging carton	Weight per pc.
smartSWITCH 5DP 14f	28001538	10 pc(s).	0.057 kg

Specific technical data

Type	Inputs			Output, relay (L)		
	Max. Smart SWITCH sensors	Sensor cable length	L' (switched phase)	Max. switching output (e.g. LCA) ⁹⁾	Max. switching output [W]	Max. switching output [VA]
smart SWITCH 5DP 14f	1	0,54 m	220 – 240 V	2	500 W	200 VA

⁹⁾ Due to the inrush current, not more than 2 Driver with a total power of 500 W can be connected to the smartSWITCH controller.

ACCESSORIES

5DPI 14f Mounting Kit

Product description

- Mounting frame for attaching all 5DP 14f sensor directly to the luminaire housing
- Shutter for preventing movement detection in one direction
- Glow wire test with 750 °C according to EN 61347-1



Ordering data

Type	Article number	Packaging carton	Weight per pc.
5DPI 14f mounting kit	28001558	100 pc(s).	0.004 kg
5DPI 14f mounting kit black	28001575	100 pc(s).	0.004 kg

1. Standards

EN 61347-1
 EN 61347-2-11
 EN 61000-3-2
 EN 61547
 EN 55015

2. Installation

2.1 Wiring diagram

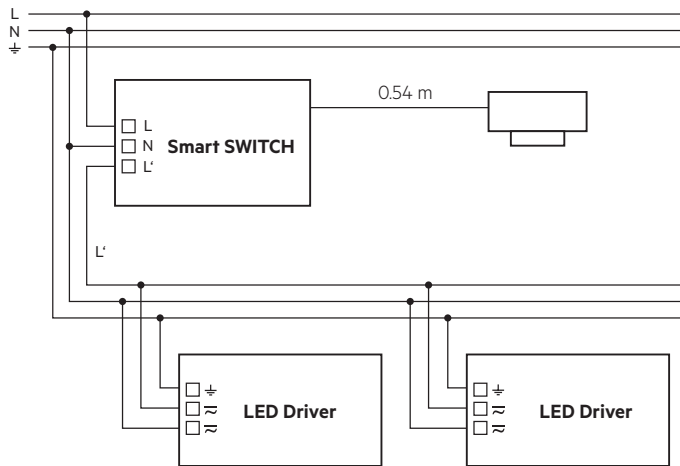

2.2 smartSWITCH Sensor

cable entry point on the side

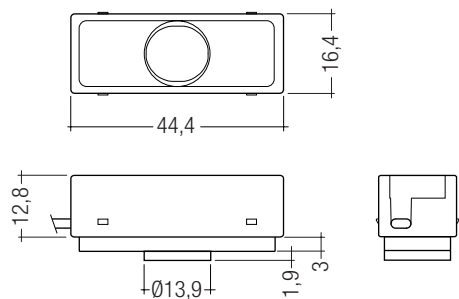

Ultra-compact luminaire mounted sensor for ambient light and detection of movement.

2.3 Mounting variants luminaire housing:

Size of the sheet: 0.8 – 1.8 mm

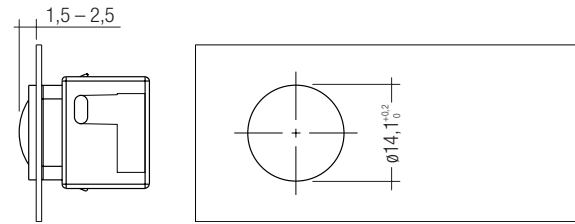

Size of the sheet: 0.8 – 3.0 mm

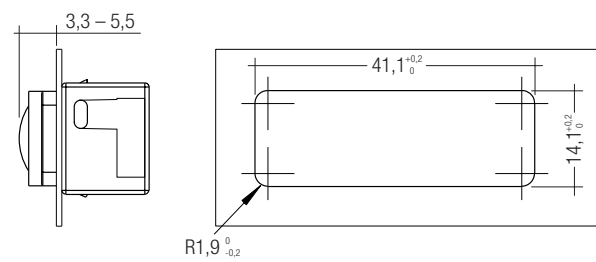

2.4 Mounting in luminaire housing with Mounting Kit:

Size of the sheet: 0.8 – 2.0 mm

Dimension drawing for needed mounting opening

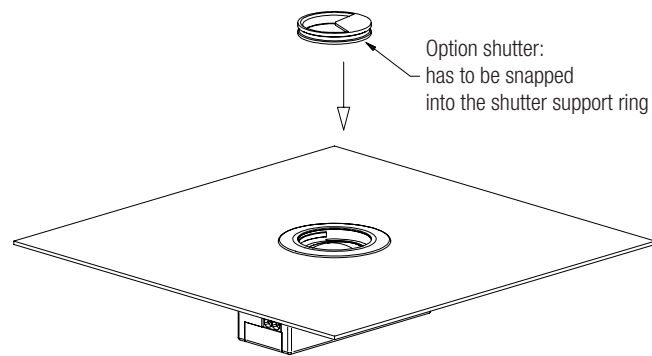
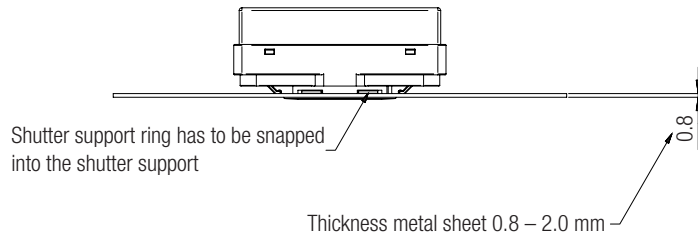
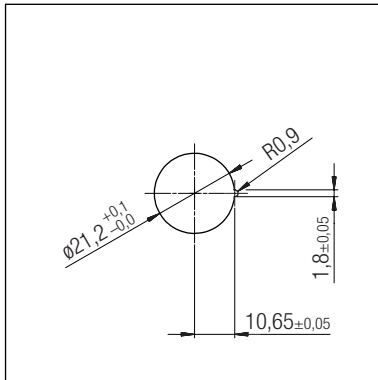

2.5 Mounting Kit mounting

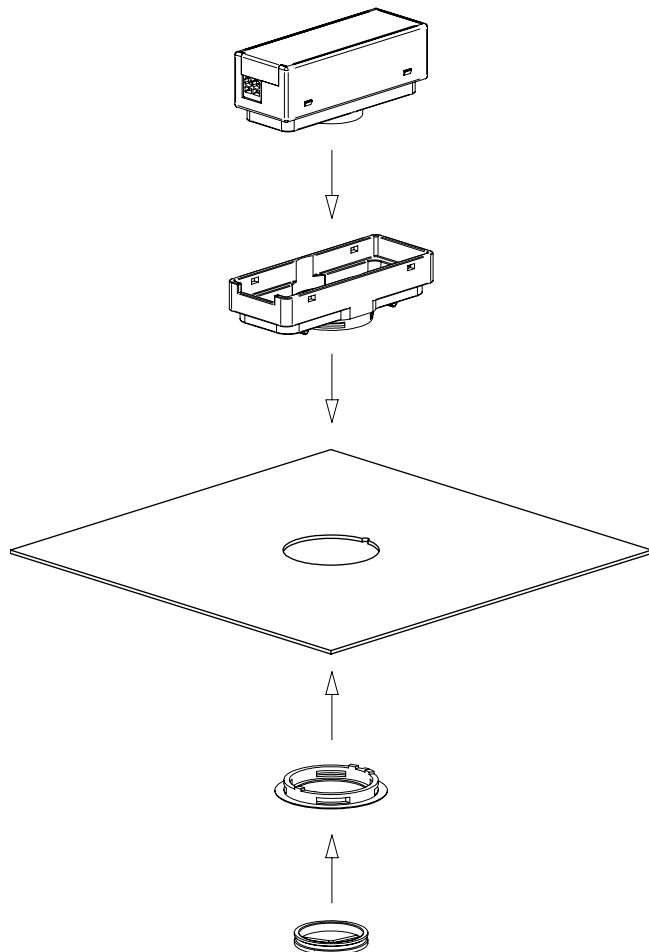

2.6 Mounting Kit Shutter

Area which is masked by the shutter.

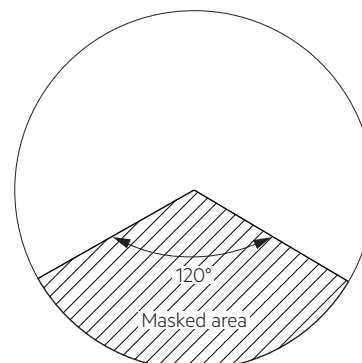
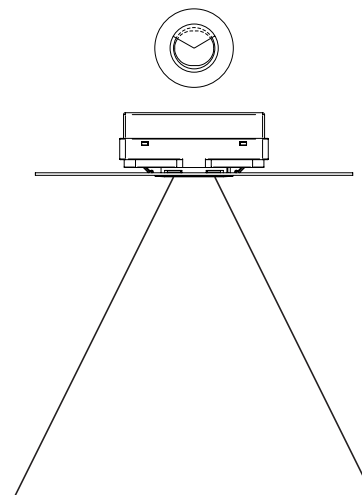

2.7 Mounting in class II luminaire

The Sensor provides basic insulation as required by IEC 62386-101 and defined in IEC 61347-1.

If the sensor is built in to a class II luminaire which has to provide double or reinforced insulation it has to be considered that the Sensor is not a class II device. Still the Sensor can be used for such projects as the front of the sensor is tested to fulfill the class II requirements for double or reinforced insulation.

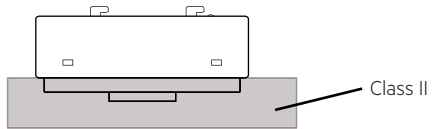

3. Sensor functions

3.1 Light level recognition area

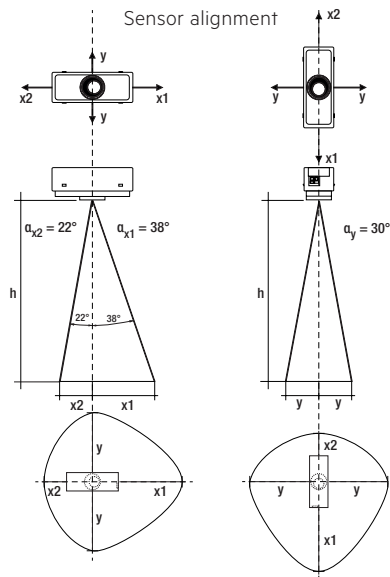

Example for light and motion detection area at height of 1.7 m:

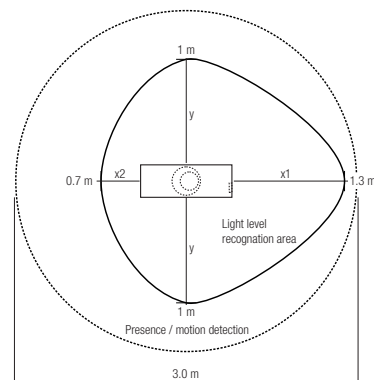

3.2 Presence / motion detection

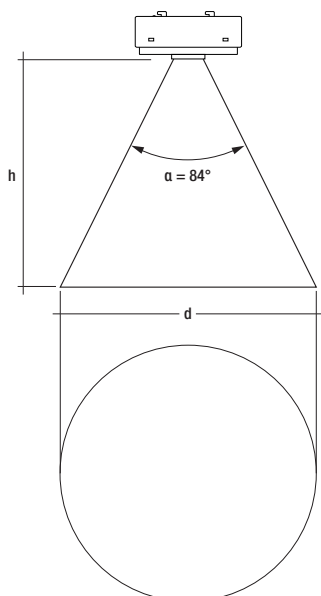

h *	x1	x2	y	d
1.7 m	1.3 m	0.7 m	1.0 m	3.0 m
2.0 m	1.6 m	0.8 m	1.2 m	3.6 m
2.3 m	1.8 m	0.9 m	1.3 m	4.1 m
2.5 m	2.0 m	1.0 m	1.4 m	4.5 m
2.7 m	2.1 m	1.1 m	1.6 m	4.9 m
3.0 m	2.3 m	1.2 m	1.7 m	5.4 m
3.5 m	2.7 m	1.4 m	2.0 m	6.3 m
4.0 m	3.1 m	1.6 m	2.3 m	7.2 m

* The recommended maximum room height for office applications is 3 m and for corridor applications for example 4 m. Up to 2 m mounting height presence is detected and over 2 m motion is detected.

Calculation of the diameter (light area):

$$x1 = \tan(\alpha_{x1}) \times h$$

$$x2 = \tan(\alpha_{x2}) \times h$$

$$y = \tan(\alpha_y) \times h$$

Calculation of the diameter (motion area):

$$d = 2 \times \tan(0.5 \times \alpha) \times h$$

3.3 Adjustments

Potentiometer times = 5s, 2m, 5m, 15m, 30m, default = 5 s
 (Note: Only discrete steps are selectable, no intermediate values)
 Potentiometer lux = 50 – 500 lx, default = off

Bright-out:
 Bright-out will be activate if postilion off is not selected.

No adjustable parameters:

Switch OFF light level: 250 % of the adjustable switch ON light level

Bright-out delay time: 10 min.

Power up behavior: When power up, the smartSWITCH will switch ON

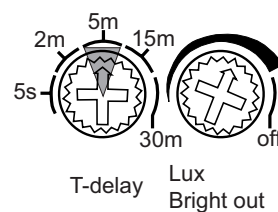

In the example above the 5 minute range is selected.

4. Miscellaneous

4.1 Additional information

Additional technical information at www.tridonic.com → Technical Data

Guarantee conditions at www.tridonic.com → Services

Life-time declarations are informative and represent no warranty claim.
 No warranty if device was opened.